

Lowe's Home Improvement Warehouse

Project:
 Commercial Development

Client:
 Lowe's Companies of Canada

The Opportunity:
 Provide ongoing expert planning advice.

MSH Genuine Results

MSH was retained by Lowe's Companies Canada ULC in 2005, as part of a multidisciplinary team charged with facilitating Lowe's entry into the Canadian retail home improvement marketplace. MSH was tasked with providing due diligence planning reports, ongoing expert planning advice, as well as facilitating any required municipal planning approvals. Now with 27 stores open across Ontario and Alberta, the Lowe's development team has been successful in achieving the growth targets set by this major commercial interest.

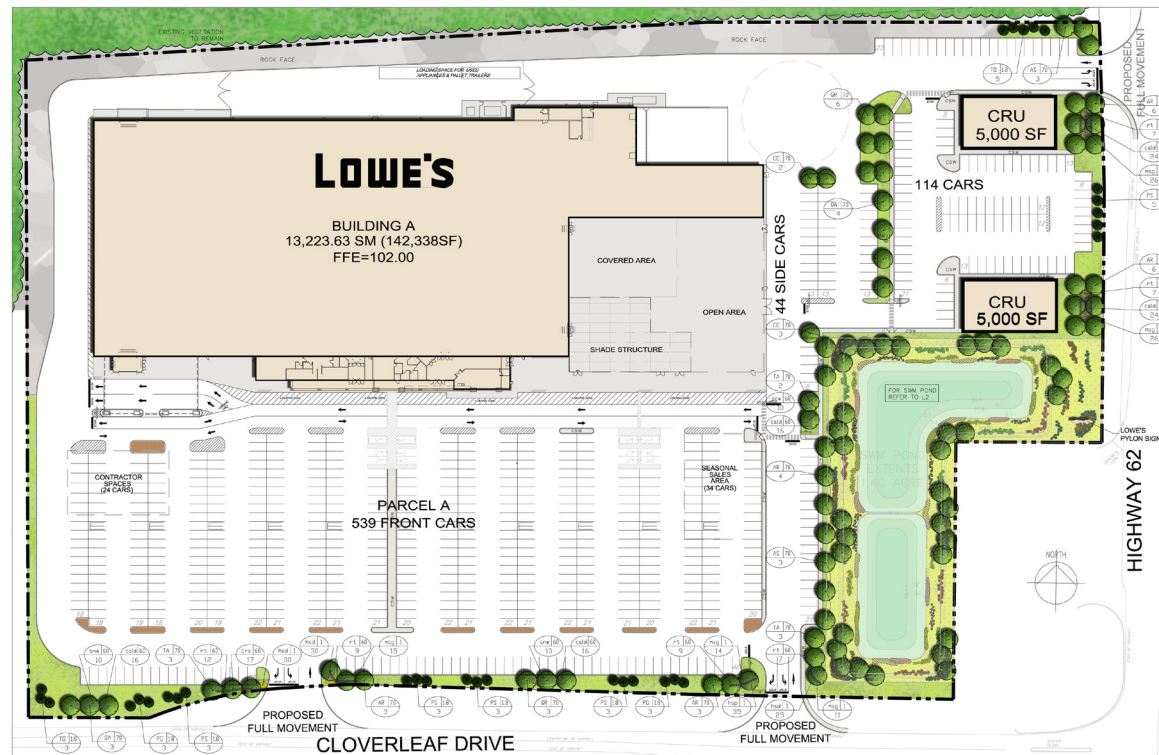
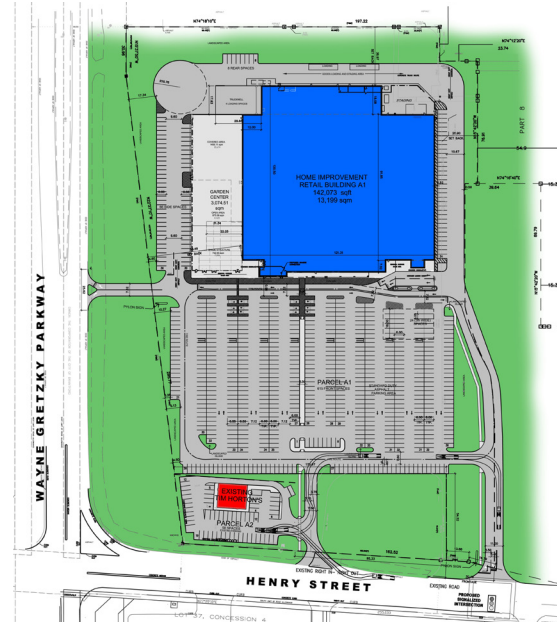

Maculay Shiomi Howson Ltd
 600 Annette Street
 Toronto, ON M6S 2C4
 T: 416-487-4101
 F: 416-487-5489

471 Timothy Street
 Newmarket, ON L3Y 1P9
 T: 905-868-8230
 F: 905-868-8501