

Harbour Road Land Use Study

Project:
Land Use Study

Client:
City of Oshawa, Ontario

The Opportunity:
Planning expertise and advice.

MSH Genuine Results

Heading up a multidisciplinary study team, MSH was retained by the City of Oshawa to revisit previously established directions for this area, and provide a new Plan that acknowledges the current cost of environmental remediation, potential for land acquisition by the City, as well as addressing several potential new development proposals. The Harbour Road Land Use Study provided input into the broader and more general Oshawa Waterfront Master Plan.

Throughout the study process, extensive public consultation and workshops were held to formulate a community vision and gather valuable stakeholder input. The plan for this 18.6 hectare area, ultimately provides for approximately 700-1,600 residential units in a variety of housing types, with an estimated population between 1,500 and 3,500 people.

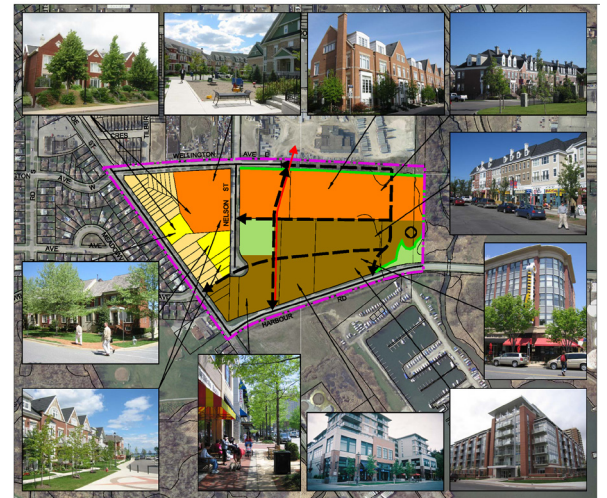
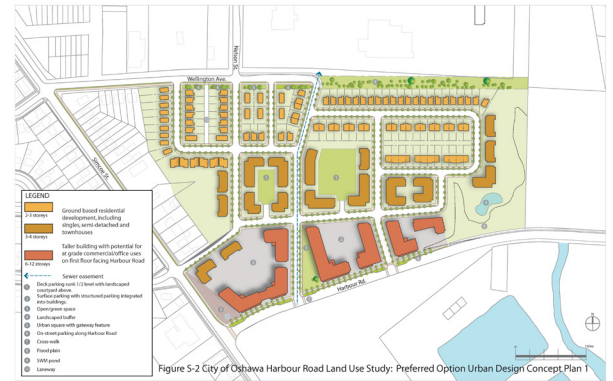

Macaulay Shiomi Howson Ltd
600 Annette Street
Toronto, ON M6S 2C4
T: 416-487-4101
F: 416-487-5489

471 Timothy Street
Newmarket, ON L3Y 1P9
T: 905-868-8230
F: 905-868-8501